

DIGLP, GOLF VILLA

COMPETITION ENTRY

The competition entry included 6 zones to be designed out of which I was in charge of designing ZONE 2. The building experiments with edges and angles. This zone had opportunities of designing community group housing villas with more emphasis on the public zones which were spill overs of the private villas.



VIEW OF TYPICAL ZONE 2 VILLAS



COMMUNAL SPACES WITHIN ZONE 2A

MASTER PLAN



DIGLP, GOLF VILLA

COMPETITION ENTRY

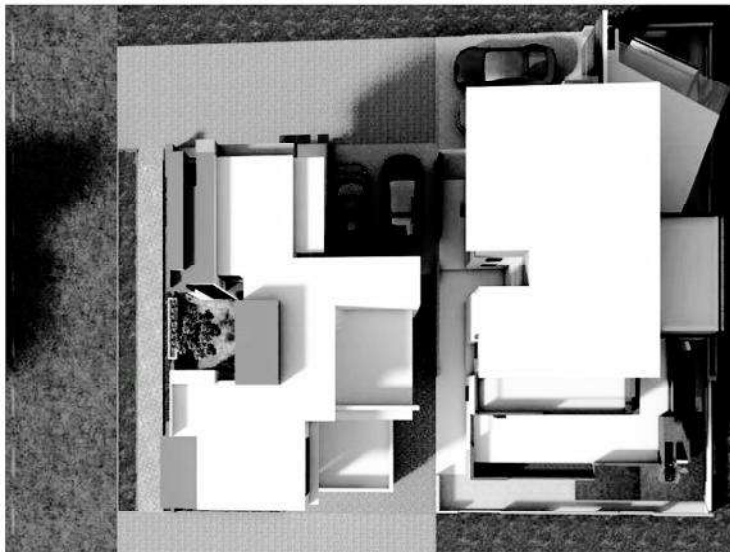

VIEW OF ADJACENT PLOTS



GROUND FLOOR PLAN

GOLF COURSE



ZONE 2 TYPOLOGIES



ZONE 2 SITE PLAN



ZONE 2 AND ZONE 2A SEPARATION